

Revisions			
Rev.	Description	Date	Approved

**MS-27048**  
 Drawing No.: \_\_\_\_\_ Rev.: \_\_\_\_\_

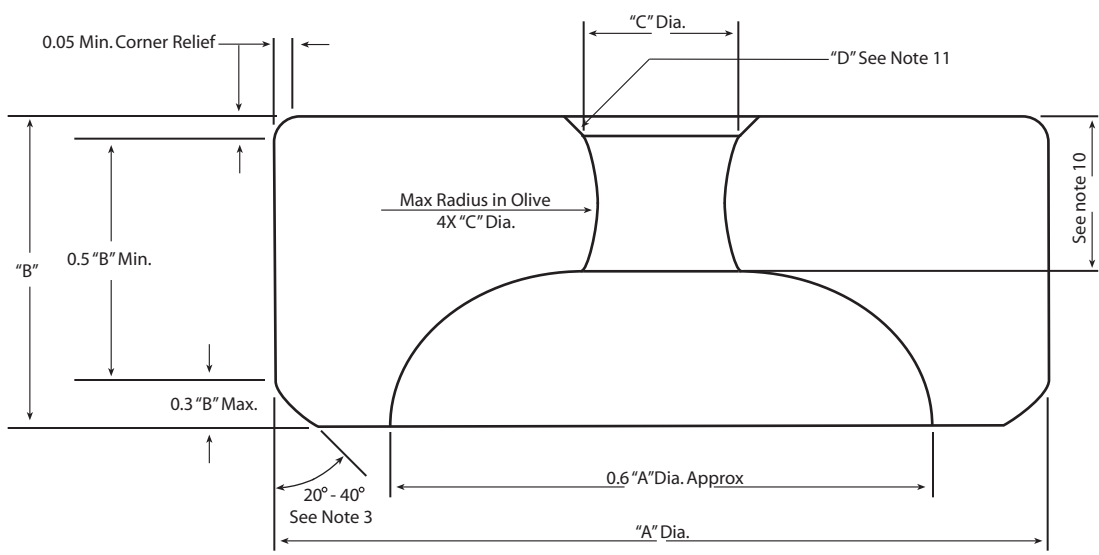

MS Part No.	A		B		C		D
	Inches	MM	Inches	MM	Inches	MM	MM
-3	0.040	1.01-1.02	0.010	0.22-0.26	0.0040	0.100-0.104	0.02 to 0.08
-5	0.050	1.26 to 1.27	0.0125	0.29 to 0.34	0.0048	0.120-0.124	
-7					0.0063	0.160-0.164	
-9					0.0080	0.200-0.204	
-11	0.0100	0.254-0.259	0.020	0.45 to 0.50	0.0125	0.318-0.323	0.06 to 0.12
-13	0.0625	1.59 to 1.60			0.0157	0.398-0.403	
-14					0.0183	0.465-0.470	
-14A	0.0200	0.508-0.513					
-15	0.080	2.03 to 2.04	0.031	0.75 to 0.80	0.0250	0.635-0.640	
-16					0.0313	0.794-0.800	
-17					0.0400	1.019-1.025	
-18	0.100	2.525 to 2.540	0.031	0.75 to 0.80	0.0500	1.269-1.275	0.09 to 0.15
-19					0.0625	1.5875-1.5950	
-20	0.156	3.95 to 3.97	0.031	0.75 to 0.80	0.0800	2.0300-2.0375	
-21					0.0800	2.0300-2.0375	

**Notes:**

1. All dimensions in mm unless otherwise noted.
2. Drawing not to scale.
3. Chamfer shape at the option of the jewel manufacturer.
4. Break all sharp corners except the intersection of cup and flat surface must be well defined.
5. The flat surfaces will be parallel within 0.01 per mm of outside diameter.
6. Diameter's "A" and "C" to be round within 0.005
7. Diameter's "A" and "C" to be concentric within 0.01
8. Diameter "A" must be perpendicular to flat side within 2°.
9. Flat on cup side must be large enough to align jewel in it setting.
10. Depth and shape of cup is at the option of the manufacturer, but the length of the hole may not exceed DIA "C" nor be less than 1/3 DIA "C".
11. "D" Dimension clearance for pivot fillet radius. Shape at the option of the jewel manufacturer.
12. Minimum diameter of olive must occur in the middle third of hole length with its plane parallel to the flat surface within 0.02 per mm of outside diameter.

213 1st ST NW - PO Box 280  
 Rolla, ND 58367  
 701-477-3193 (P) - 701-477-6579 (F)  
 www.microlap.com

**MS-27048**  
 Drawing No.: \_\_\_\_\_ Rev.: \_\_\_\_\_

Proprietary and Confidential

This drawing and the information contained in the specifications are the exclusive and proprietary property of Microlap Technologies, Inc. This information and materials shall not be disclosed, divulged, reproduced, copied or used in any manner without the express written authorization of Microlap Technologies, Inc. All copies, reproductions, or other duplications of any portion of this information or materials shall include this legend.

**Bearing, Jewel - Olive Hole, Single Cup  
 Military Standard**

See Notes	Ruby/Sapphire
Finish Requirements:	Material:
cg Drawn By:	dv Approved By:
5/2008 Date:	6/2008 Date: